



# MASTER LEDbulb Designer

## MASTER LEDbulb Lamp Cover Concave

MASTER LEDbulb Designer combines warm, incandescent-like light with customisable MASTER LEDlamp covers to offer design freedom in a simple retrofit LED bulb like never before. Ideal for open fixtures where the bulb is fully visible, it offers the excellent light performance, dimming and energy savings of MASTER LEDbulbs along with a uniquely customisable design. It is particularly suited to the hospitality and retail industry, where aesthetic design is especially important. The elegant MASTER LEDlamp covers can be individually selected and installed by the user to match the surrounding décor, also as it changes over the extended lifetime of the lamp. The innovative lamp design ensures excellent light quality, and the broadly compatible dimmable driver helps create the desired ambiance while further improving efficiency

### Product data

#### • General Characteristics

Cap-Base	-
Bulb	Cover Concave [Cover Concave]
Bulb Finish	- [-]

#### • Light Technical Characteristics

Colour Code	- [Not Specified]
Colour Designation	- [Not Specified]
Beam Angle	0 D
Colour Temperature	0 K

#### • Electrical Characteristics

Wattage	0 W
Voltage	0 V

#### • Measuring Conditions

Switching cycle	50000x
-----------------	--------

#### • Product Dimensions

Diameter D	63.6 mm
------------	---------

Overall Length C	39.8 mm
------------------	---------

#### • Product Data

Order code	171805 00
Full product code	871829117180500
Full product name	MASTER LEDbulb Lamp Cover Concave
Order product name	MASTER LEDbulb Lamp Cover Concave
Pieces per pack	1
Packing configuration	6
Packs per outerbox	6
Bar code on pack - EAN1	8718291171805
Bar code on outerbox - EAN3	8718291171812
Logistic code(s) - 12NC	929000208702
Net weight per piece	0.036 kg

Dimensional drawing

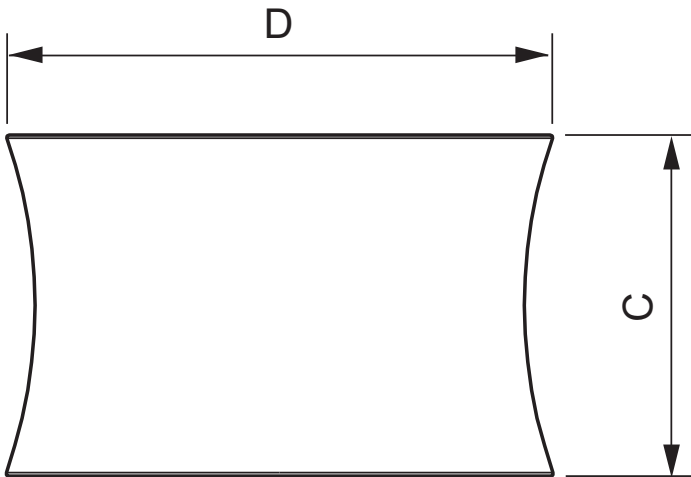

Lamp cover concave

Product	C (Norm)	C1 (Max)	D (Norm)	D1 (Norm)
LED Lamp Cover Concave	39.8	-	63.6	-



© 2012 Koninklijke Philips Electronics N.V.  
All rights reserved.

Specifications are subject to change without notice. Trademarks are the property of Koninklijke Philips Electronics N.V. or their respective owners.

[www.philips.com/lighting](http://www.philips.com/lighting)

2012, February 18  
data subject to change